

The Mouldsworth

5 bedroom detached house with integral double garage



Seddon Homes.co.uk

Ground floor

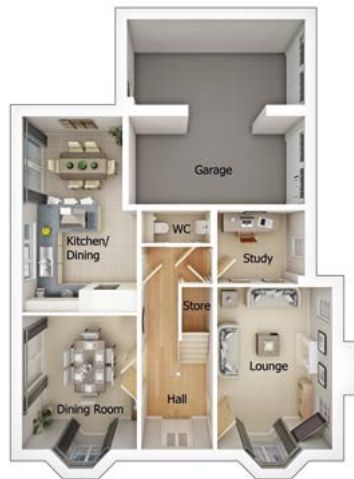

Lounge (into bay)	11'0" x 17'1"
Dining Room (into bay)	11'0" x 14'3"
Kitchen/Dining	11'0" x 18'9"
Study	8'5" x 7'1"
WC	6'8" x 3'3"
Garage	17'0" x 17'11"

First floor



Master Bedroom	14'7" x 13'2"
En Suite 1	8'3" x 8'1"
Bedroom 2	11'1" x 10'7"
En Suite 2	11'1" x 4'8"
Bedroom 3	12'2" x 8'6"
Bedroom 4	11'1" x 10'5"
Bedroom 5	11'1" x 7'8"
Bathroom	6'7" x 7'1"

Artists' impressions are drawn from an imaginary viewpoint within an open space and are intended to give an impression of the house design. Photographs are from Seddon Homes developments across the North West and are intended to show typical street scenes. Neither the artists' impressions nor the photographs are intended to give an accurate description of any specific property offered for sale, its setting or its surroundings. These do not show final details of gradients of land, boundary treatments, local authority street lighting or landscaping. We aim to build according to the layout, but occasionally we do have to change house designs, boundaries, landscaping and the positions of roads, footpaths, street lighting and other features as the development proceeds. Floor plans: The dimensions shown are approximate. Each home is built individually and so the precise measurements may vary from that shown, although every endeavour is made to make the dimensions as accurate as possible. We give maximum dimensions that include fitted wardrobes, sloping ceilings, bay windows, and any other features. All layouts, including kitchens, are for illustrative purposes only and may differ by development. Please speak to your Sales Advisor for more information.