

The Ashton

2 bedroom semi detached/detached house with parking spaces *(side bay to some plots)*



Seddon Homes.co.uk

Ground floor



Lounge/Dining Area	13'11" x 12'6"
Kitchen	10'11" x 10'3"
WC	5'9" x 3'11"

First floor

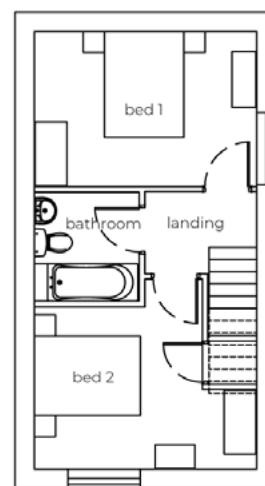

Master Bedroom	13'11" x 9'8"
Bedroom 2	13'11" x 10'2"
Bathroom	6'8" x 6'10"