

# The Rishton

3 bedroom semi detached house with parking spaces



**Seddon Homes.co.uk**

Ground floor



Lounge	14'3" x 9'8"
Kitchen/Dining	10'0" x 13'3" (into bay)
WC	6'4" x 3'9"

First floor

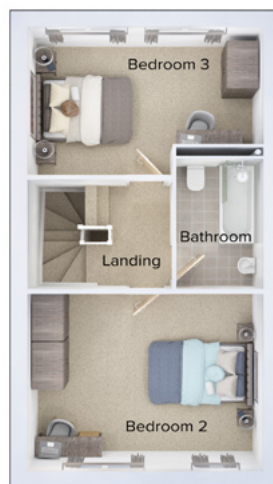

Bedroom 2	14'3" x 11'7"
Bedroom 3	14'3" x 7'8"
Bathroom	5'2" x 8'6"

Second floor

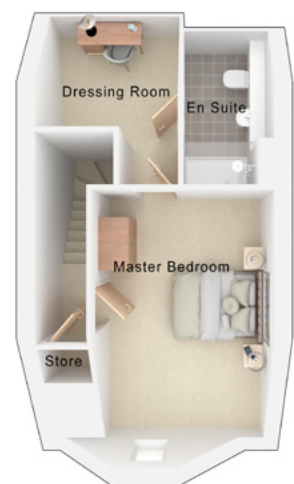

Master Bedroom	10'11" x 12'5"
En Suite	4'6" x 9'10"
Dressing Room	8'7" x 6'6"

The dimensions shown are approximate. Each home is built individually and so the precise measurements may vary from that shown, although every endeavour is made to make the dimensions as accurate as possible. We give maximum dimensions that include fitted wardrobes, sloping ceilings, bay windows, and any other features. All layouts, including kitchens, are for illustrative purposes only. Please speak to your Sales Advisor for more information.