

The Carron

4 bedroom detached house with integral single garage



Seddon Homes.co.uk

Ground floor

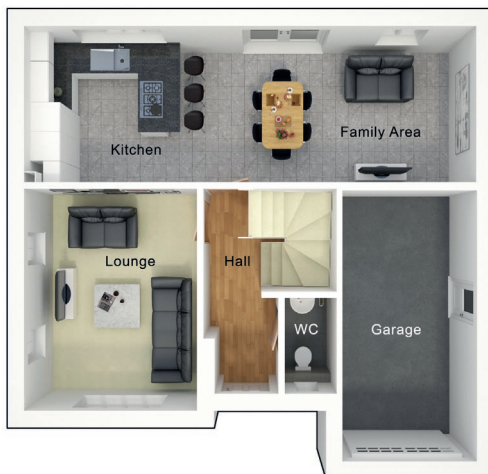

Lounge	3498mm x 4500mm
Kitchen/Family Area	9123mm x 3173mm
WC	1075mm x 1956mm
Garage	2710mm x 5513mm

First floor



Master Bedroom	3870mm x 3683mm
En Suite	2620mm x 1200mm
Bedroom 2	2873mm x 4200mm
Bedroom 3	3498mm x 3010mm
Bedroom 4	2230mm x 2245mm
Bathroom	2735mm x 2035mm

N.B. All dimensions shown are maximum structural dimensions and do not include plaster finish. CGI shows typical Carron house. Seddon Homes pursues a policy of continuous improvement. So whilst every effort has been made to ensure that this information is correct, it is intended only as a guide and the company reserves the right to alter the specification as necessary and without prior notice. Please note that the layout of some homes may be the reverse of that shown here. Specific properties may also differ from this picture in respect of window positioning, brick colour and other design details including no garage, so please check with the Sales Advisor if clarification is required. This does not constitute or form any part of a contract or sale.

Dukes Rise Off Brandlesholme Road Bury Gtr Manchester BL8 1GW Tel: 01925 839504