

The Firgrove

3 bedroom mews house with integral single garage



Seddon Homes.co.uk

Ground floor

First floor

Second floor

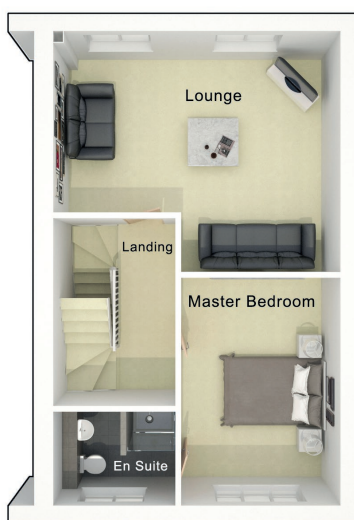

Kitchen/Dining	3593mm x 5273mm
WC	970mm x 1700mm
Garage	3055mm x 4980mm

Lounge	3820mm x 5273mm
Master Bedroom	2923mm x 4778mm
En Suite	1725mm x 2275mm

Bedroom 2	3008mm x 3388mm
Bedroom 3	4168mm x 2414mm
Bathroom	2032mm x 2215mm

N.B. All dimensions shown are maximum structural dimensions and do not include plaster finish. CGI shows typical Firgrove house. Seddon Homes pursues a policy of continuous improvement. So whilst every effort has been made to ensure that this information is correct, it is intended only as a guide and the company reserves the right to alter the specification as necessary and without prior notice. Please note that the layout of some homes may be the reverse of that shown here. Specific properties may also differ from this picture in respect of window positioning, brick colour and other design details including no garage, so please check with the Sales Advisor if clarification is required. This does not constitute or form any part of a contract or sale.

Bridgefold 3 Bridgefold Road Rochdale OL11 5BT Tel: 01706 342791