

# The Lawton

3 bedroom detached house with integral single garage



Seddon Homes.co.uk

Ground floor

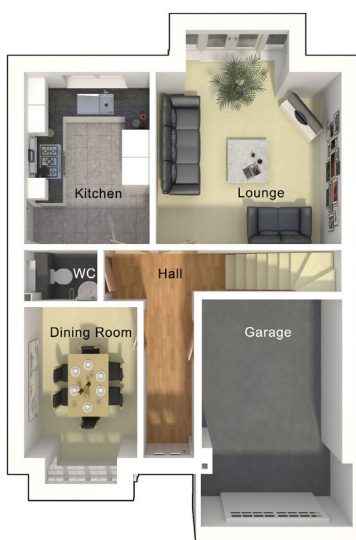

Lounge	4036mm x 4633mm
Kitchen	2737mm x 3733mm
Dining Room	2472mm x 3835mm
WC	1612mm x 1130mm
Garage	3025mm x 4885mm

First floor

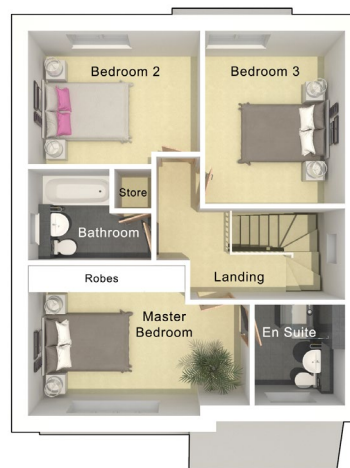

Master Bedroom	4818mm x 3275mm
En Suite	1980mm x 2207mm
Bedroom 2	3051mm x 3758mm
Bedroom 3	3747mm x 2905mm
Bathroom	2692mm x 2005mm

N.B. All dimensions shown are maximum structural dimensions and do not include plaster finish. CGI shows typical Lawton house. Seddon Homes pursues a policy of continuous improvement. So whilst every effort has been made to ensure that this information is correct, it is intended only as a guide and the company reserves the right to alter the specification as necessary and without prior notice. Please note that the layout of some homes may be the reverse of that shown here. Specific properties may also differ from this picture in respect of window positioning, brick colour and other design details including no garage, so please check with the Sales Advisor if clarification is required. This does not constitute or form any part of a contract or sale.

**Crofton** Hassall Road Alsager Cheshire ST7 2SL Tel: 01925 839504