

# The Thornley

4 bedroom detached house with integral single garage



Ground floor



Media Room	4735mm x 2685mm
Utility	2210mm x 1650mm
WC	2210mm x 1040mm
Garage	2992mm x 4930mm

First floor

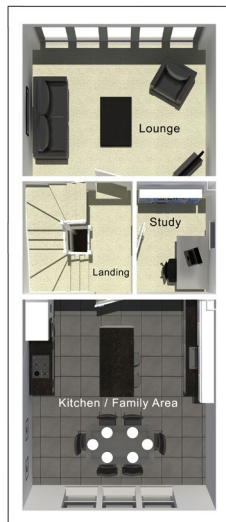

Lounge	4735mm x 3725mm
Kitchen/Family	4735mm x 5160mm
Study	1957mm x 2775mm

Second floor

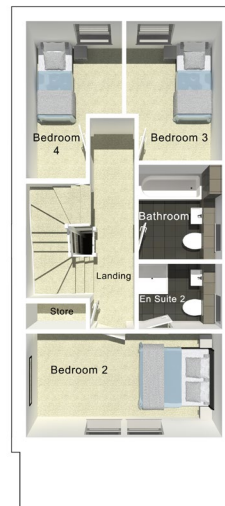

Bedroom 2	4735mm x 2525mm
Bedroom 3	2330mm x 3800mm
Bedroom 4	2330mm x 3373mm
En Suite 2	2030mm x 1600mm
Bathroom	2030mm x 2300mm

Third floor



Master Bed	4735mm x 3800mm
En Suite 1	2030mm x 2775mm

N.B. All dimensions shown are maximum structural dimensions and do not include plaster finish. CGI shows typical Thornley house. Seddon Homes pursues a policy of continuous improvement. So whilst every effort has been made to ensure that this information is correct, it is intended only as a guide and the company reserves the right to alter the specification as necessary and without prior notice. Please note that the layout of some homes may be the reverse of that shown here. Specific properties may also differ from this picture in respect of window positioning, brick colour and other design details including no garage, so please check with the Sales Advisor if clarification is required. This does not constitute or form any part of a contract or sale.

**Waterside** Egerton Road Belmont Bolton BL7 8BN Tel: 01204 811 480